



Recoila

HOSE AND CORD REELS

C SERIES

HEAVEY DUTY MULTI PURPOSE REELS

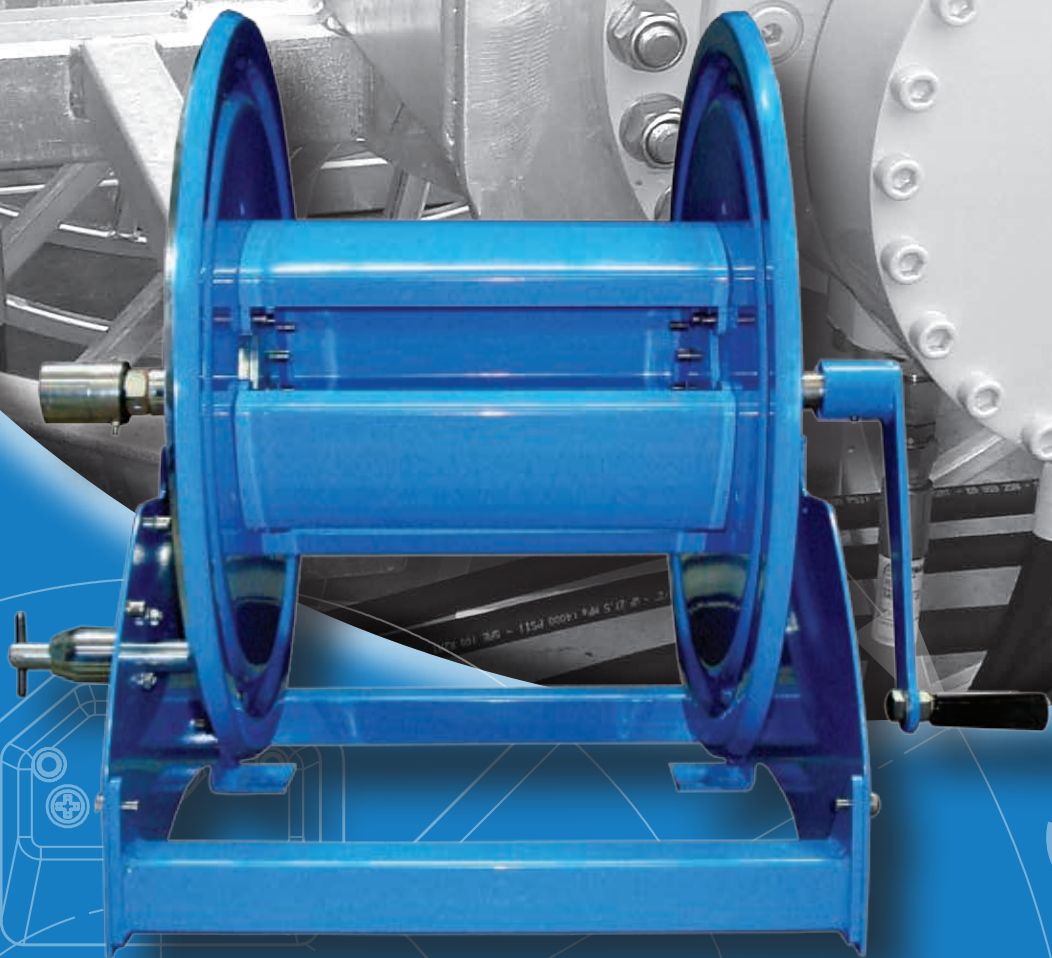

30



HOSE REELS.

Our total, dedicated business.

We've been making hose reels for decades - over 38 years in fact - and this manufacturing wisdom, coupled with competitive pricing, knowledgeable staff, a wealth of technical information and solid after-sales service positions us firmly at the forefront of our industry.

Our head office and factory is based in Sydney Australia, with a well-stocked distribution centre in Auckland NZ, as well as reputable distribution partners across the globe.

ReCoila has a fully equipped production facility and a team of experts to ensure our reels are designed and manufactured to exacting standards.

With a comprehensive range of hose, cord and cable reels and a dedicated custom design and manufacturing team, ReCoila can supply the right reel for your individual application - with safety and productivity in mind.

AUSTRALIAN MANUFACTURING. INTERNATIONAL DISTRIBUTION.

ReCoila is a proudly Australian company based in Western Sydney, with distribution reach across Australia, New Zealand and internationally.

We have resellers strategically based in key metro and regional areas to ensure delivery to customers is as swift as possible, and long standing relationships with our freight carriers mean that logistics are coordinated efficiently.

AUSTRALIAN MADE + QUALITY IMPORTS = COMPREHENSIVE RANGE.

Our range constitutes a wealth of engineered polypropylene and heavy duty steel and stainless steel reels, supplemented with hand-picked reels from some of the world's best manufacturers, to present a truly comprehensive product portfolio. And, our ability to design and manufacture customised reels in-house means that we're sure to have a reel to suit your needs.

VISIT
RECOILA
ONLINE





ENGINEERED CONFIDENCE.

WHY USE HOSE REELS?

Hose management and minimising risk



HAZARD:

DO HOSES REGULARLY LAY ACROSS PATHS AND WORK AREAS?



HAZARD:

ARE HOSES HEAVY OR AWKWARD TO MOVE?



HAZARD:

DO POORLY MANAGED OR POORLY MAINTAINED HOSES CREATE WET, SLIPPERY WORK AREAS?



HAZARD:

ARE HOSES BEING DAMAGED DUE TO POOR STORAGE, FOR EXAMPLE BEING RUN OVER BY FORKLIFTS OR VEHICLES?



HOW HOSES BECOME HAZARDS

You're no doubt aware that trips, falls and ergonomic injuries are common in even the most strictly regulated work environments.

Workplaces use hoses and cables for all manner of applications, each one carrying potential safety risks such as:

- Trips and falls due to stray hoses and cables
- Ergonomic injury if heavy, awkward hoses need to be moved
- Leakage (& consequently wet areas) causing slip hazards.

HOSE LIFE CAN BE AFFECTED TOO

Hoses themselves when left on the floor can be weakened by environmental contaminants, cleaning chemicals, being run over by work vehicles, or being bent or coiled tighter than the hoses natural bend radius, and will ultimately fail as the structure of the hose is weakened.

THE SOLUTION – AND THE FLOW ON BENEFITS

ReCoila can offer a high quality hose and cable management solution that can reduce the risk of trips and falls from hoses and improve your safety record.

Aside from making your workplace safer, the use of ReCoila hose reels will increase productivity through providing operators a more effective means of handling hoses, cords and cables in the workplace.

Higher productivity, reduced downtime and lower maintenance costs are an additional benefit of efficient hose management.



C SERIES

Heavy duty, multi-purpose



Ideally suited for a variety of applications, this simple but tough hose reel will handle a multitude of hose sizes, lengths and pressures.

The main axle is supported by ball bearings while the adjustable friction brake allows you to add or remove drag to prevent over spooling. The spool lock holds the spool fixed during transit, preventing overrun, and the open spool design allows air flow to help dry out wet areas and allow for easy cleaning.

A bolt together frame and spool constructed of 3mm steel plate offers easy access for maintenance and servicing.

Plus, the unique modular design of the C Series also allows the user to add or change drive systems in the field using a simple bolt on process.

C SERIES HAND CRANK REELS

APPLICATION

A simple, heavy duty hand crank hose reel for a wide range of applications.

HOSE TYPE

Supplied with or without hose

MEDIA

As per your hose type

CONSTRUCTION MATERIALS

Carbon Steel
304 Stainless Steel
316 Stainless Steel
Aluminium

FINISH

Powder Coated
Galvanized

OPTIONAL EXTRAS

4 way roller guides
Gear guard
Extra heavy duty wrap spreaders*
Wall mount swivel bracket

Standard construction material is carbon steel.

*Note: we recommend heavy duty wrap spreaders for pressures above 2000 psi.



FEATURES

C10480300
LEFT HAND VERSION



C SERIES HAND CRANK

| Model | Hose ID (mm) | Hose Capacity (m) | Max PSI | Overall Width (G) |
|-------------|--------------|-------------------|---------|-------------------|
| C6480150 | 6 | 60 | 5000 | 505 |
| C6480300 | 6 | 140 | 5000 | 655 |
| C6480450 | 6 | 240 | 5000 | 805 |
| C6480600 | 6 | 300 | 5000 | 955 |
| C10480150 | 10 | 40 | 5000 | 505 |
| C10480300 | 10 | 100 | 5000 | 655 |
| C10480450 | 10 | 145 | 5000 | 805 |
| C10480600 | 10 | 200 | 5000 | 955 |
| C12480150 | 12 | 30 | 5000 | 505 |
| C12480300 | 12 | 60 | 5000 | 655 |
| C12480450 | 12 | 100 | 5000 | 805 |
| C12480600 | 12 | 130 | 5000 | 955 |
| C19480150 | 19 | 15 | 5000 | 505 |
| C19480300 | 19 | 30 | 5000 | 655 |
| C19480450 | 19 | 40 | 5000 | 805 |
| C19480600 | 19 | 60 | 5000 | 955 |
| C25480300 | 25 | 20 | 3000 | 655 |
| C25480450 | 25 | 30 | 3000 | 805 |
| C25480600 | 25 | 45 | 3000 | 955 |
| CH38640350* | 32 - 38 | 20 | 1500 | 734 |

DIMENSIONS

C **6** **480** **150**
Series Hose ID (mm) Overall depth (B) Wrap width (F)

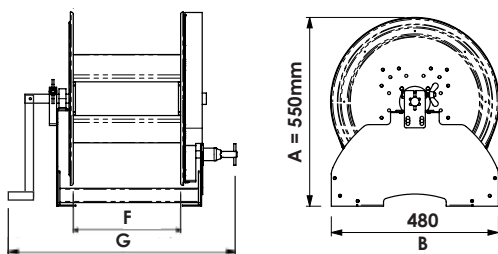

Detailed dimensional drawings available on request.
Quote drawing number ST11093-A.1

*CH Series Dimensions:

A = 680mm, B = 560mm, F = 350mm, G = 734mm

= Quick Ship Item, see inside back cover for more information.

C SERIES 12VDC MOTOR DRIVEN REELS

APPLICATION

The 12VDC C Series reel is suitable for a wide range of applications where a motor driven reeling system is required.

HOSE TYPE

Supplied with or without hose

MEDIA

As per your hose type

CONSTRUCTION MATERIALS

Carbon Steel
304 Stainless Steel
316 Stainless Steel
Aluminium

FINISH

Powder Coated
Galvanized

OPTIONAL EXTRAS

4 way roller guides
Gear guard
Friction brake
Extra heavy duty wrap spreaders*
Wall mount swivel bracket

Standard construction material is carbon steel.

*Note: we recommend heavy duty wrap spreaders for pressures above 2000 psi.

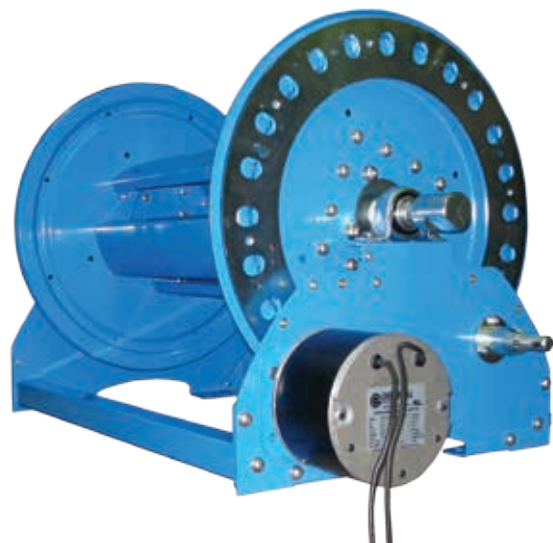

EE19480600
RIGHT HAND VERSION

FEATURES



C SERIES 12VDC MOTOR DRIVEN

| Model | Hose ID (mm) | Hose Capacity (m) | Max PSI | Overall Width (G) |
|-------------|--------------|-------------------|---------|-------------------|
| EE6480150 | 6 | 60 | 5000 | 386 |
| EE6480300 | 6 | 140 | 5000 | 536 |
| EE6480450 | 6 | 240 | 5000 | 686 |
| EE6480600 | 6 | 300 | 5000 | 836 |
| EE10480150 | 10 | 40 | 5000 | 386 |
| EE10480300 | 10 | 100 | 5000 | 536 |
| EE10480450 | 10 | 145 | 5000 | 686 |
| EE10480600 | 10 | 200 | 5000 | 836 |
| EE12480150 | 12 | 30 | 5000 | 386 |
| EE12480300 | 12 | 60 | 5000 | 536 |
| EE12480450 | 12 | 100 | 5000 | 686 |
| EE12480600 | 12 | 130 | 5000 | 836 |
| EE19480150 | 19 | 15 | 5000 | 386 |
| EE19480300 | 19 | 30 | 5000 | 536 |
| EE19480450 | 19 | 40 | 5000 | 686 |
| EE19480600 | 19 | 60 | 5000 | 836 |
| EE25480300 | 25 | 20 | 3000 | 536 |
| EE25480450 | 25 | 30 | 3000 | 686 |
| EE25480600 | 25 | 45 | 3000 | 836 |
| EE38640350* | 32 - 38 | 20 | 1500 | 640 |

DIMENSIONS

EE 6 480 150
Series Hose ID (mm) Overall depth (B) Wrap width (F)

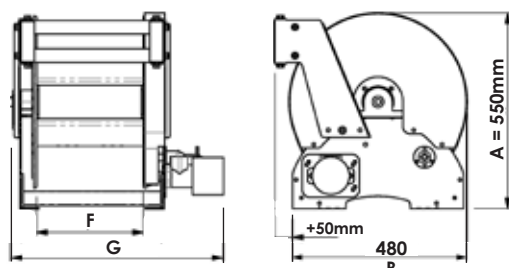

Detailed dimensional drawings available on request.
Quote drawing number ST11093-A.1

*CH Series Dimensions:

A = 680mm, B = 560mm, F = 350mm, G = 640mm

= Quick Ship Item, see inside back cover for more information.

C SERIES 24VDC MOTOR DRIVEN REELS

APPLICATION

Simple, heavy duty models for a wide range of applications. Supplied with a high quality 24VDC motor for effortless operation.

HOSE TYPE

Supplied with or without hose

MEDIA

As per your hose type

CONSTRUCTION MATERIALS

Carbon Steel
304 Stainless Steel
316 Stainless Steel
Aluminium

FINISH

Powder Coated
Galvanized

OPTIONAL EXTRAS

4 way roller guides
Gear guard
Friction brake
Extra heavy duty wrap spreaders*
Wall mount swivel bracket

Standard construction material is carbon steel.

*Note: we recommend heavy duty wrap spreaders for pressures above 2000 psi.



EA19480600
RIGHT HAND VERSION

FEATURES



C SERIES 24VDC MOTOR DRIVEN

| Model | Hose ID Capacity (mm) | Hose Capacity (m) | Max PSI | Overall Width (G) |
|-------------|-----------------------|-------------------|---------|-------------------|
| EA6480150 | 6 | 60 | 5000 | 386 |
| EA6480300 | 6 | 140 | 5000 | 536 |
| EA6480450 | 6 | 240 | 5000 | 686 |
| EA6480600 | 6 | 300 | 5000 | 836 |
| EA10480150 | 10 | 40 | 5000 | 386 |
| EA10480300 | 10 | 100 | 5000 | 536 |
| EA10480450 | 10 | 145 | 5000 | 686 |
| EA10480600 | 10 | 200 | 5000 | 836 |
| EA12480150 | 12 | 30 | 5000 | 386 |
| EA12480300 | 12 | 60 | 5000 | 536 |
| EA12480450 | 12 | 100 | 5000 | 686 |
| EA12480600 | 12 | 130 | 5000 | 836 |
| EA19480150 | 19 | 15 | 5000 | 386 |
| EA19480300 | 19 | 30 | 5000 | 536 |
| EA19480450 | 19 | 40 | 5000 | 686 |
| EA19480600 | 19 | 60 | 5000 | 836 |
| EA25480300 | 25 | 20 | 3000 | 536 |
| EA25480450 | 25 | 30 | 3000 | 686 |
| EA25480600 | 25 | 45 | 3000 | 836 |
| EA38640350* | 32 - 38 | 20 | 1500 | 640 |

DIMENSIONS

EA 6 480 150
Series Hose ID (mm) Overall depth (B) Wrap width (F)

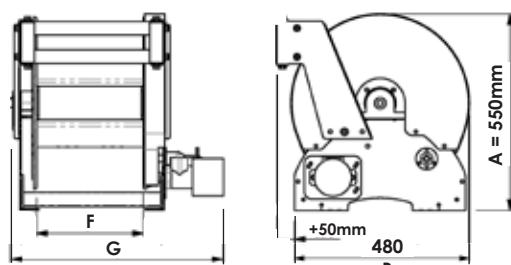

Detailed dimensional drawings available on request.
Quote drawing number ST11093-A.1

*CH Series Dimensions:

A = 680mm, B = 560mm, F = 350mm, G = 640mm

= Quick Ship Item, see inside back cover for more information.

C SERIES 4AM PNEUMATIC DRIVE REELS

APPLICATION

The pneumatic drive C Series reel is suitable for a wide range of applications where a motor driven reeling system is required. Supplied with a high quality 4AM pneumatic motor for effortless operation.

HOSE TYPE

Supplied with or without hose

MEDIA

As per your hose type

CONSTRUCTION MATERIALS

Carbon Steel
304 Stainless Steel
316 Stainless Steel
Aluminium

FINISH

Powder Coated
Galvanized

OPTIONAL EXTRAS

4 way roller guides
Gear guard
Friction brake
Extra heavy duty wrap spreaders*
Wall mount swivel bracket

Standard construction material is carbon steel.

*Note: we recommend heavy duty wrap spreaders for pressures above 2000 psi.



A19480600
RIGHT HAND VERSION

FEATURES



C SERIES PNEUMATIC MOTOR DRIVEN

| Model | Hose ID Capacity (mm) | Hose Capacity (m) | Max PSI | Overall Width (G) |
|------------|-----------------------|-------------------|---------|-------------------|
| A6480150 | 6 | 60 | 5000 | 370 |
| A6480300 | 6 | 140 | 5000 | 520 |
| A6480450 | 6 | 240 | 5000 | 670 |
| A6480600 | 6 | 300 | 5000 | 820 |
| A10480150 | 10 | 40 | 5000 | 370 |
| A10480300 | 10 | 100 | 5000 | 520 |
| A10480450 | 10 | 145 | 5000 | 670 |
| A10480600 | 10 | 200 | 5000 | 820 |
| A12480150 | 12 | 30 | 5000 | 370 |
| A12480300 | 12 | 60 | 5000 | 520 |
| A12480450 | 12 | 100 | 5000 | 670 |
| A12480600 | 12 | 130 | 5000 | 820 |
| A19480150 | 19 | 15 | 5000 | 370 |
| A19480300 | 19 | 30 | 5000 | 520 |
| A19480450 | 19 | 40 | 5000 | 670 |
| A19480600 | 19 | 60 | 5000 | 820 |
| A25480300 | 25 | 20 | 3000 | 520 |
| A25480450 | 25 | 30 | 3000 | 670 |
| A25480600 | 25 | 45 | 3000 | 820 |
| A38640350* | 32 - 38 | 20 | 1500 | 640 |

DIMENSIONS

A Series
6 Hose ID (mm)
480 Overall depth (B)
150 Wrap width (F)

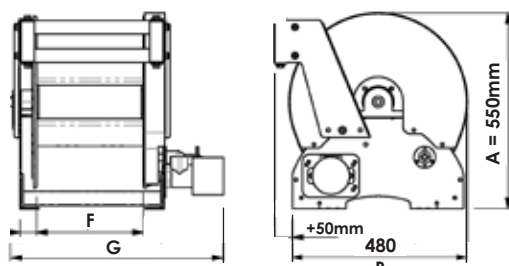

Detailed dimensional drawings available on request.
Quote drawing number ST11093-A.1

*CH Series Dimensions:

A = 680mm, B = 560mm, F = 350mm, G = 640mm

= Quick Ship Item, see inside back cover for more information.

C SERIES HYDRAULIC DRIVE REELS

APPLICATION

Simple, heavy duty hydraulic motor driven models for a wide range of applications. Supplied with a high quality hydraulic motor for effortless operation.

HOSE TYPE Supplied with or without hose

MEDIA As per your hose type

CONSTRUCTION MATERIALS Carbon Steel (standard)
304 Stainless Steel
316 Stainless Steel
Aluminium

FINISH Powder Coated
Galvanized

OPTIONAL EXTRAS 4 way roller guides
Gear guard
Friction brake
Extra heavy duty wrap spreaders*
Wall mount swivel bracket

Standard construction material is carbon steel.

*Note: we recommend heavy duty wrap spreaders for pressures above 2000 psi.

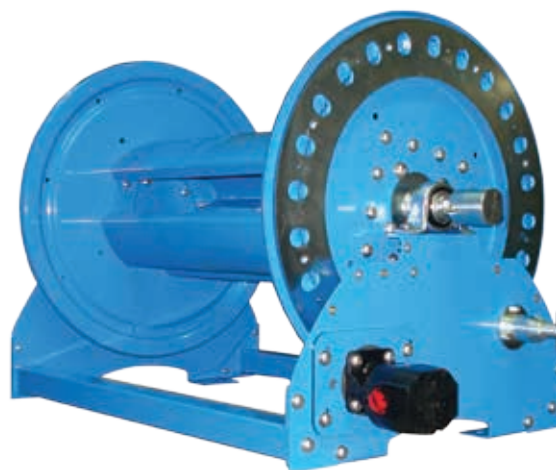

H19480600
RIGHT HAND VERSION

FEATURES



C SERIES HYDRAULIC MOTOR DRIVEN

| Model | Hose ID Capacity (mm) | Hose Capacity (m) | Max PSI | Overall Width (G) |
|------------|-----------------------|-------------------|---------|-------------------|
| H6480150 | 6 | 60 | 5000 | 370 |
| H6480300 | 6 | 140 | 5000 | 520 |
| H6480450 | 6 | 240 | 5000 | 670 |
| H6480600 | 6 | 300 | 5000 | 820 |
| H10480150 | 10 | 40 | 5000 | 370 |
| H10480300 | 10 | 100 | 5000 | 520 |
| H10480450 | 10 | 145 | 5000 | 670 |
| H10480600 | 10 | 200 | 5000 | 820 |
| H12480150 | 12 | 30 | 5000 | 370 |
| H12480300 | 12 | 60 | 5000 | 520 |
| H12480450 | 12 | 100 | 5000 | 670 |
| H12480600 | 12 | 130 | 5000 | 820 |
| H19480150 | 19 | 15 | 5000 | 370 |
| H19480300 | 19 | 30 | 5000 | 520 |
| H19480450 | 19 | 40 | 5000 | 670 |
| H19480600 | 19 | 60 | 5000 | 820 |
| H25480300 | 25 | 20 | 3000 | 520 |
| H25480450 | 25 | 30 | 3000 | 670 |
| H25480600 | 25 | 45 | 3000 | 820 |
| H38640350* | 32 - 38 | 20 | 1500 | 640 |

DIMENSIONS

H Series
6 Hose ID (mm)
480 Overall depth (B)
150 Wrap width (F)

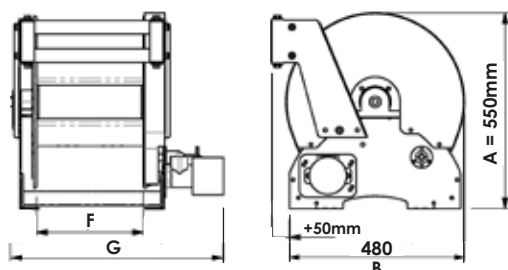

Detailed dimensional drawings available on request. Quote drawing number ST11093-A.1

*CH Series Dimensions:

A = 680mm, B = 560mm, F = 350mm, G = 640mm

= Quick Ship Item, see inside back cover for more information.



RECOILA AUSTRALIA - HEAD OFFICE
Unit 1/10 Melissa Place
Kings Park NSW 2148
Australia

Phone +61 2 9621 8988
Fax +61 2 9621 7688
sales@recoila.com.au

RECOILA NEW ZEALAND
18 Mani Street, Pukete
Hamilton 3200
New Zealand

Phone +64 7 847 4111
Fax +64 7 847 4112
sales@recoila.co.nz

www.recoila.com.au

www.recoila.co.nz

VISIT
RECOILA
ONLINE

