

Heavy Duty Spring Rewind Reels

Applications include, air, water, fuels, lubricants, chemicals for diverse industries including mining, offshore, service vehicles, workshops – anywhere a rugged reliable spring rewind reel is required for large diameter and long length hoses.

Standard units are powder coated steel and are also available in stainless steel and aluminium construction. Dual hose and high pressure versions are available.

Operating pressures - 24Hg - 10,000 PSI

Single Hose

Model	Hose capacity metres Based on a 410mm OD spool					Dimensions – mm approximate		
	1/2"	3/4"	1"	1-1/2"	2"	A	B	D
ST580150	25	10	9	0	0	620	660	395
ST580200	0	20	15	0	0	620	660	445
ST580300	0	25	20	0	0	620	660	545
ST640150	0	20	10	0	0	680	700	395
ST640200	0	25	15	0	0	680	700	445
ST640300	0	30	20	15	0	680	700	545
ST640350	0	0	30	20	10	680	700	595
ST780300	0	0	20	20	12	800	820	545

Twin Hose

Model	Hose capacity metres Based on a 410mm OD spool					Dimensions – mm approximate		
	6mm	10mm	12mm	19mm	1"	H	L	W
STT640100	30	20	15	0	0	680	700	420
STT640150	0	30	25	0	0	680	700	470
STT640200	0	0	30	0	0	680	700	520
STT780200	0	0	0	10	5	820	800	520
STT780300	0	0	0	15	10	820	800	620
STT780350	0	0	0	20	15	820	800	670



Metal Construction Open Reels Spring Rewind - Heavy Duty

ST Series Features & Benefits

ReCoila® ST heavy duty spring rewind hose and cable reels are designed for application where reliability, longevity and strength is required.

This range of reels are welded, fabricated of heavy gauge steel plate to ensure rigidity and strength.

Designed for applications such as:

- Lubrication
- Watering
- Fuel transfer
- High volume compressed air
- Food transfer
- Fire fighting

Options construction materials

- Carbon steel
- Stainless steel 316
- Aluminium

Working Pressure

- 24 Hg - 10,000 PSI

- **Compact rugged design**
- **External spring canister for easy maintenance**
- **High flow swivels and fluid paths**
- **Stainless steel roller guides with ball bearings**
- **Ball bearing main axle bearings**
- **Positive latching system**
- **Welded frame design**
- **Heavy duty roll spun flanges**
- **Stainless steel fasteners used where applicable**
- **Optional fluid path construction materials**
- **Optional pressure ratings and swivel configuration**
- **Right hand or Left hand configurations**

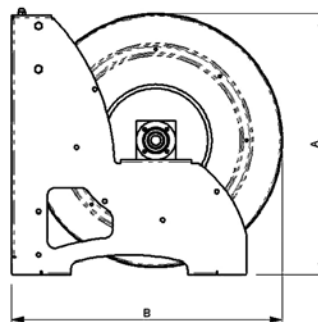

ST Series Dimensions

